

Legenda

-  AMBITO PORTUALE
-  AREE COMMERCIALE / INDUSTRIALE
-  AREE PETROLIFERE
-  AREE SERVIZIO PASSEGGERI E CROCIERISTICA
ORMEGGI ISTITUZIONALI/SERVIZI PORTUALI
-  AREE PESCHERECCI
-  AREE DEL DIPORTO NAUTICO
-  AREE TURISTICO BALNEARI

ELABORATO F

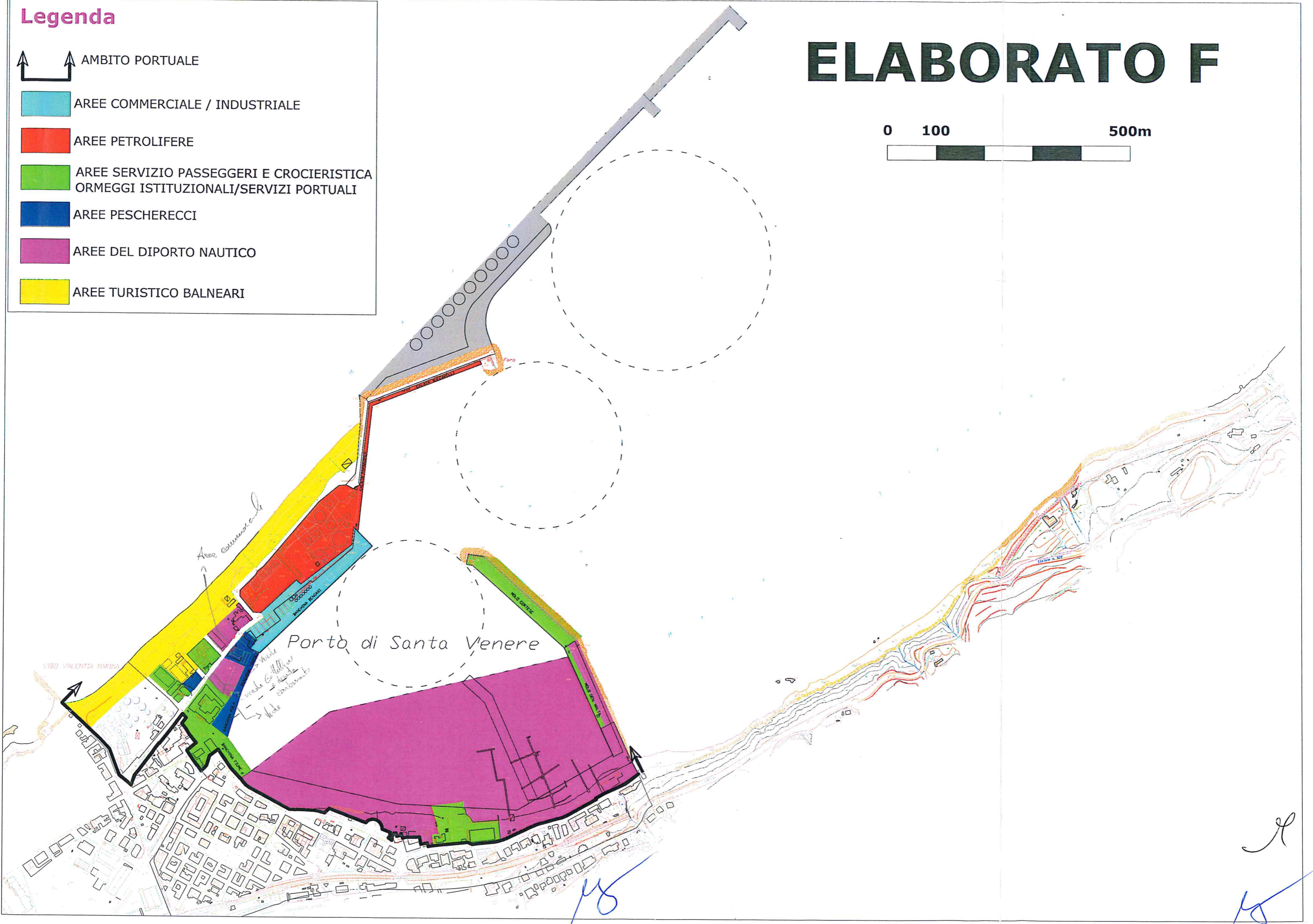

Handwritten signature in blue ink.

Handwritten signature in blue ink.